



## Product Overview



The NWH2210 Wireless Ethernet Client provides a wireless connection to the Internet or to share resources for an Ethernet-enabled device. With no software driver required for set-up, and regardless of any operating system, the NWH2210 allows not only desktop or notebook PC wirelessly accessing network, but also extends fast, simple and flexible wireless networking capabilities to printers, scanners, barcode reader, medical equipment, industrial machinery and other data collection devices, which don't have PCI or PCMCIA slot available. Featuring an integrated built-in antenna for robust operation in radio frequency hostile environments, and complying with the IEEE 802.11b standard, the NWH2210 is a high performance and Plug and Play Wireless Ethernet client.

## Key Features and Benefits

### Industrial IEEE 802.11b Standard Compliant

Complies with the IEEE 802.11b DSSS (Direct Sequence Spread Spectrum) wireless standard, ensuring full product interoperability between vendors.

### Ease of Use

The NWH2210 provides Ethernet-enabled device an easy and hassle free wireless alternative to access network. Then, simply plug an Ethernet-enabled device to the NWH2210, and ready to go wireless.

### Superior Radio performance

With advanced radio frequency technology on receiving and transmission design for best quality of data transmission, leads the outstanding performance

Advanced integrated built-in phase array antenna both better for receiving and transmission quality.

Superior receiving sensitivity enhances receiving quality on weak data signal.

### Secure Transmissions

WEP: 64 & 128-bit secured WEP (Wired Equivalent Privacy) encryption for securing wireless LAN data transmissions.

SSID: Only stations using the same SSID (Service Set ID) are permitted to communicate with each other.

### Supports Seamless Roaming:

Roam freely from Access Point to Access Point with uninterrupted network connectivity.

## Wireless Ethernet Client Application Scenarios

### Wireless Equipment Service



A business traveler in a hotel or hot spot rents a WEC at the front desk. There is no driver or utility to install - the WEC "just works," letting the customer surf the Internet as soon as it is plugged in.



# 11Mbps Wireless Ethernet Client

# NWH2210

"Unwiring" of Office and Industrial Equipment

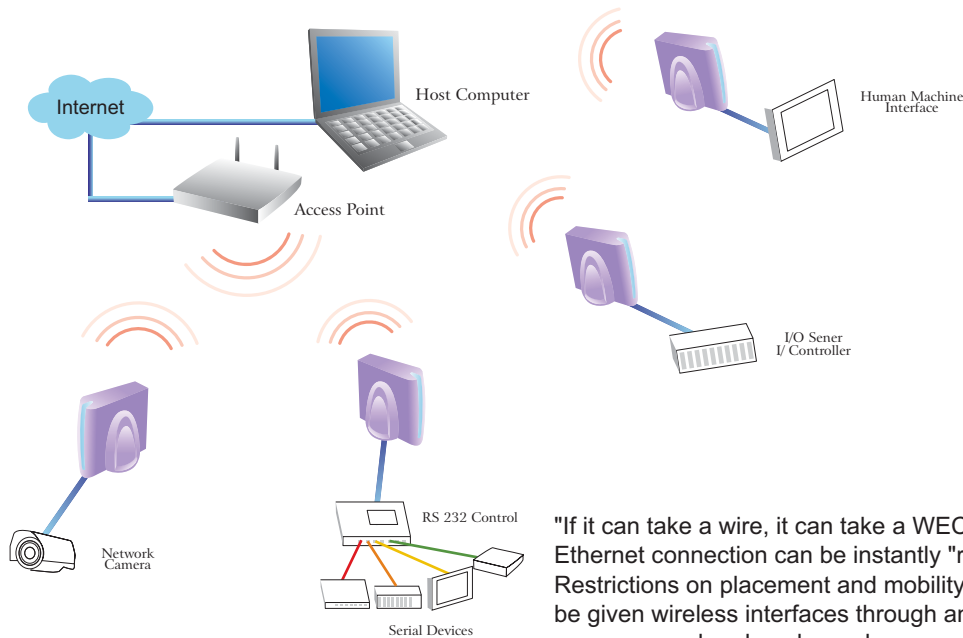

"If it can take a wire, it can take a WEC." Any device made for a wireline Ethernet connection can be instantly "released" by plugging in a WEC. Restrictions on placement and mobility then disappear. Even serial devices can be given wireless interfaces through an RS-232 server and a WEC. Network cameras can be placed anywhere, any time. Printers, I/O controllers, equipment control panels.... The list is endless. The network gains in expandability; the office or factory gains immeasurably in flexibility.

## Specifications

<b>Standards Compliance</b>	IEEE 802.11b
<b>Radio Frequency Type</b>	Direct Sequence Spread Spectrum (DSSS)
<b>Frequency Band</b>	2.4GHz
<b>Transmission Rate</b>	11/5.5/2/1Mbps auto fallback, 22Mbps (Option)
<b>Modulation Type</b>	PBCC, CCK, BPSK, QFSK
<b>Number of Operating Channels</b>	US/Canada: 11 Channels Major European country: 13 Channels Japan: 14 Channels
<b>Transmitter</b>	RF Output Power: 20 dBm (typical) Frequency stability: Within $\pm 25$ ppm
<b>Receiver</b>	Sensitivity: -82 dBm (Typical) 11Mbps @ 25°C $\pm 5$ °C
<b>Antenna Type</b>	3dBi Build-in Antenna
<b>Interface Type</b>	10/100 Ethernet Port
<b>Security</b>	64 / 128-bit WEP encryption
<b>Software Support</b>	64-bit/128-bit WEP encryption; Dynamic rate shifting: 11/5.5/2/1Mbps; Channel Setting Kick Start, Windows-based Utility
<b>Range</b>	Open space: 200 ~ 500m; Indoor 30-100m
<b>Operating Environment</b>	Operating Temperature: 0 ~ 50°C (32 ~ 122 °F) Storage Temperature: -30 ~ 70°C (-22 ~ 158 °F)
<b>Dimensions</b>	100 x 65 x 115 mm
<b>Power</b>	Power DC 5 Volt + 5%; 1.2A
<b>Warranty</b>	One year limited

## National Datacomm Corporation

4F, No.24-2, Industry East 4th Road, Science Park  
Hsin-Chu, Taiwan, R.O.C.  
Tel: +886-3-5783966  
Fax: +886-3-5777989  
Email: sales@ndc.com.tw

## NDC World Wide Web

www.ndc.com  
©2004 National Datacomm Corporation, Inc. All rights reserved.

P/N NWH2210 WEC E01-0405